

# TAHOE 13FT B

# QUICK SETUP INSTRUCTIONS

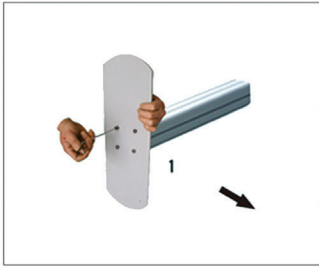

### SETUP1

Install both bottom half pole with threads to feet.

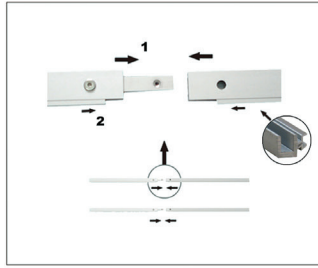

### SETUP2

Connect flat bars together.

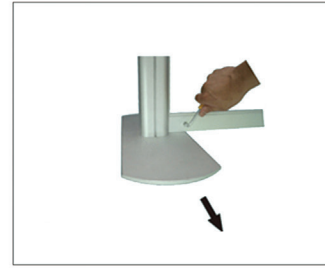

### SETUP3

Lock both bottom flat bars onto bottom half poles. Lock bottom side flat bars to bottom half poles.

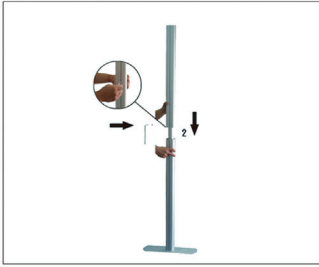

### SETUP4

Install top half pole without threads to bottom half pole. Do the same with other side.

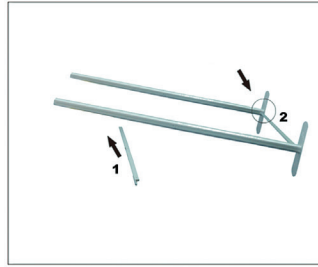

### SETUP5

Insert acrylic panel screws to both top flat bars.

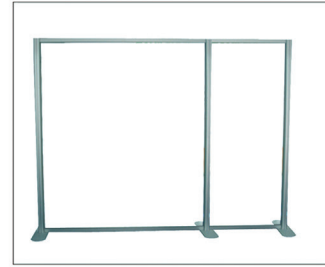

### SETUP6

Finish the main profiles.

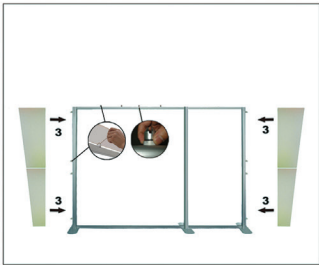

### SETUP7

Insert acrylic panels.

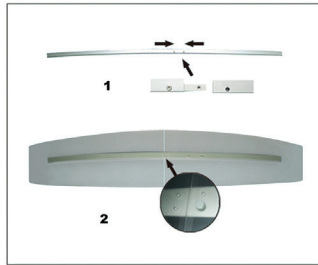

### SETUP8

Connect curve rectangle bars and then use the 4 plastic screws to attach the acrylic top canopy panels to the curve rectangle bars.

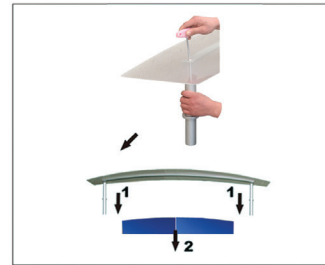

### SETUP9

Install roof graphic and connecting supporting Profiles.



### SETUP10

Insert printing fabric and lock into place the three aluminum shelves.



### SETUP11

Set up table accessories then connect them to main poles with bracket.



### SETUP12

Insert the "T" shaped screws and pot on the nut. Push the "T" into the profile making sure the "T" screw is in the locking position.

